



The property is located at the corner of McBride Street and Highway 30. The property had been used as a mobile home park.

The property is level and all utilities serve the site.

LOCATION: McBride Street and Highway 30

Tax lots 700, 900, 1000, 1100, 1200, 1600, 1800 and 1900

**SEALED BIDS DUE NO LATER THAN 5:00 PM, NOVEMBER 18, 2015**

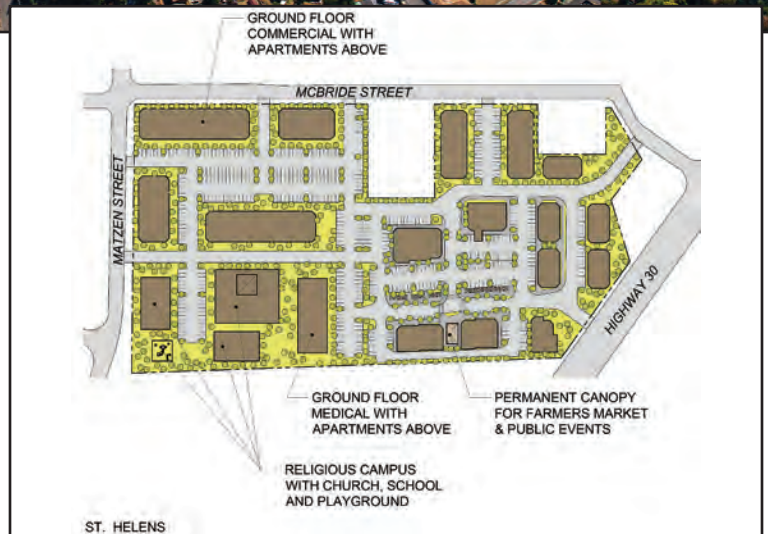

*Please Note: Sketch plan is conceptual only. Neither the Seller nor its agents have submitted plan or made any applications to a public agency.*